



iCare+

Installation steps



GENERAL ICARE FUNCTIONING

General functioning

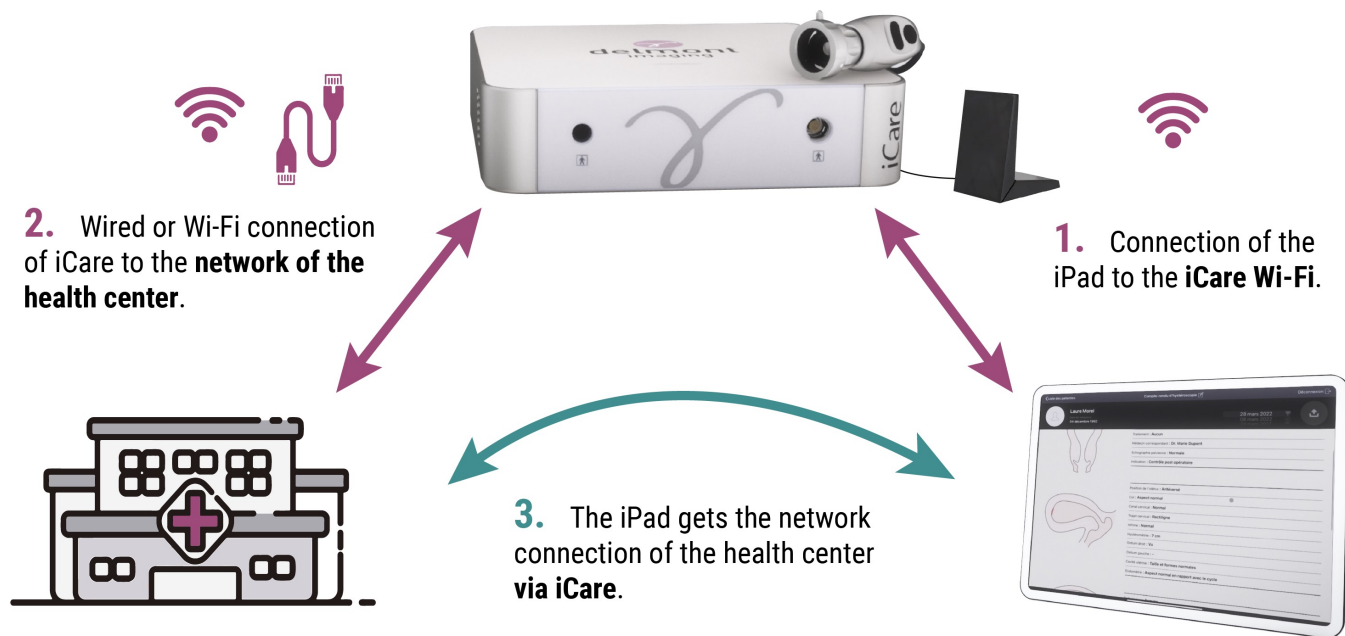

iCare Wi-Fi



Video stream from iCare is both transmitted to the monitor via HDMI but also in real time to imagyn via Wi-Fi.



A Wi-Fi antenna transmits the iCare Wi-Fi.

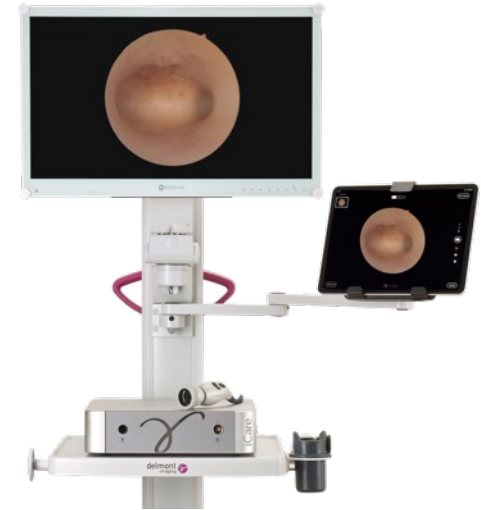

The iPad must be connected to the iCare Wi-Fi when using the imagyn App in order to:

- Get the exam in streaming;
- Retrieve the images;
- Control some parameters of the camera (take pictures, change the brightness, colors...).



Connection of the iCare to the health center network

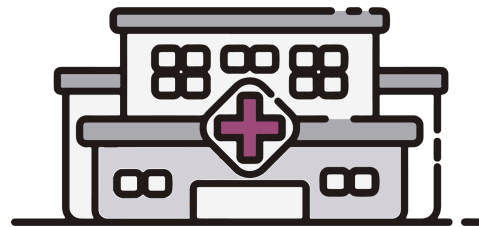

It is possible to connect the iCare to the health center network.

The iCare will act like a gateway: the iPad will access to the health center network through the iCare.

- In a hospital or a clinic: the iPad will access to the health center network resources (printers, mail servers, interoperability...)
- In an office: the iPad will access to the internet network.



STEP 1: CART AND MONITOR

Infusion stand & camera basket

The cart is delivered **partially** assembled. The monitor, VESA holder, camera basket and the infusion stand remain to be installed.

1. The infusion stand

Screw the two parts of the infusion stand together:



Insert the complete infusion stand, using the alignment failsafe, through the cover until it stops:



2. The camera basket

Place the camera head basket in its support.



Monitor and Vesa holder (1/3)

3. The monitor and its monitor Vesa holder



Remove the monitor holder by unscrewing the 4 allen screws of the holder.

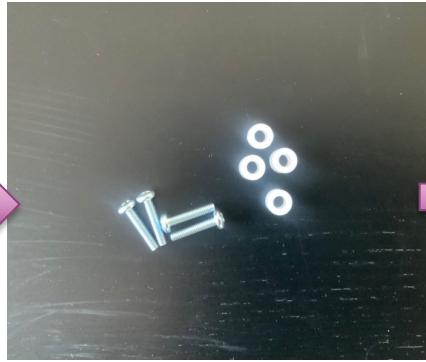

Take the 4 spacers and the 4x2cm screws (supplied in the packaging of the cart).



Place the 4 spacers on the back of the monitor as in the picture.



Screw the VESA holder to the monitor.

Monitor and Vesa holder (2/3)



Remove the 2 screws on the iCare cart.



Place the VESA holder, replace and tighten the screws.



Connect the 2 parts of the monitor power cable.



Remove the 2 covers. Plug the power cable to the electrical outlet of the cart and thread the cable through the cart.

Monitor and Vesa holder (3/3)



Connect the power cable at the back of the monitor and put back the 2 covers of the cart.

- 4. Plug the power cable of the cart to a power socket.**



STEP 2: ICARE



1. Place the iCare on the highest shelf of the cart. Without the cart, place the iCare on a plane ventilated surface (at least 15cm around the unit).

2. Connect the storage USB stick on one of the two USB outlets.

3. Connect a HDMI cable to the iCare and thread it through the cart to plug the other end to the monitor.

4. Connect the power cable to the iCare and thread it through the cart to plug the other end to the electrical outlet of the cart.



iCare Wi-Fi Antenna (1/3)

Installation with a cart

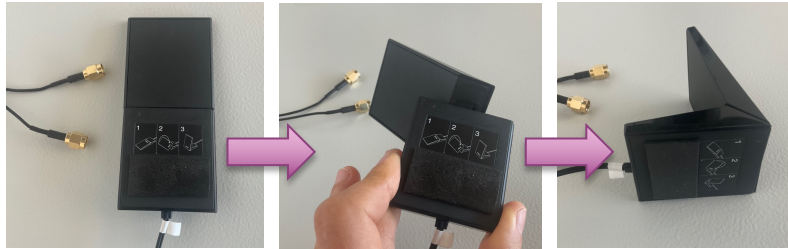

1. Rotate gently the Wi-Fi antenna.



2. Tape the Wi-Fi antenna under the upper shelf of the cart and thread the cable through the cart.

iCare Wi-Fi Antenna (2/3)

Installation without a cart



OR



OR



1-2. Rotate the Wi-Fi antenna to place it on or next the iCare. It can also be tapped vertically on the wall.



The Wi-Fi antenna must not be placed close to the HDMI outlets.

iCare Wi-Fi Antenna (3/3)

3. Screw the 2 connectors of the Wi-Fi antenna at the rear of the iCare.



Be careful to turn the metal connectors and not the cables themselves to avoid any damage!





Connection to the health center

Always privilege a wired (Ethernet) connection, if possible, to improve the system stability! Wired connection is quicker and safer (less interferences) than Wi-Fi.



Wired connection

If there is an active RJ45 outlet available:

Connect an ethernet cable between the health center RJ45 outlet and the Ethernet port.



Wi-Fi connection

If not:

Plug a Wi-Fi stick on the the remaining USB outlet of the rear pannel.

Turn ON the cart & iCare

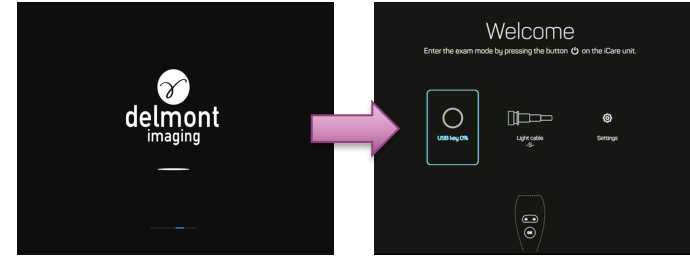
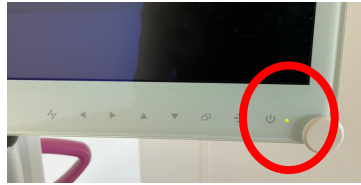

1. Turn ON the iCare using the green power switch on the cart and the power switch at the rear panel of the iCare unit.

2. Turn on the monitor by touching the ON button. The light will turn green.

3. The loading screen is displayed on the monitor during 30sec and the indicator light on the right panel of iCare unit flashes rapidly.
The home page will then appear and the indicator light will flash slowly, indicating that iCare is ready for use.

Camera head

Place the camera head in the basket and connect it to the control unit. The two dots must be aligned.

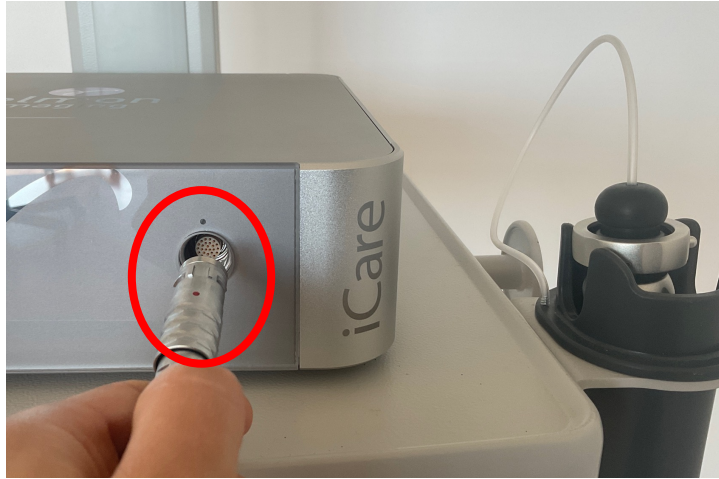

You should hear a « click » when the camera is correctly plugged.





STEP 3: NAS (OPTIONAL)

NAS PACK



1. NAS box and its power cable

2. Wi-Fi repeater

3. Ethernet cable

4. Imagyn licence card

The NAS is an external backup of the imagyn database.

Each NAS pack is created to function with 1 predefined iCare and 1 predefined imagyn licence!

General functioning



NAS installation

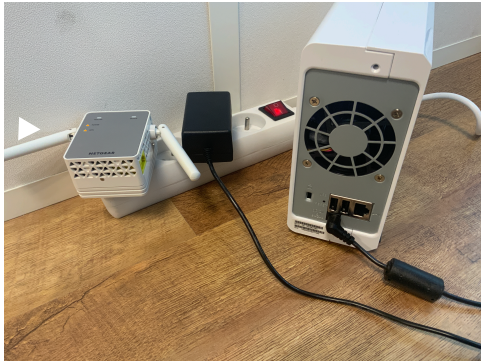

1. Plug the NAS and Repeater in the same room as your iCare.

The NAS does not require any manipulation after installation and must remain plugged in. We advise you to position it in a safe place.

2. Connect the NAS to the repeater using an Ethernet cable.

3. Turn ON the repeater and the NAS.

After several seconds, a beeper sounds and the lights will start flashing green, indicating that the NAS is ready to operate.

NAS Check

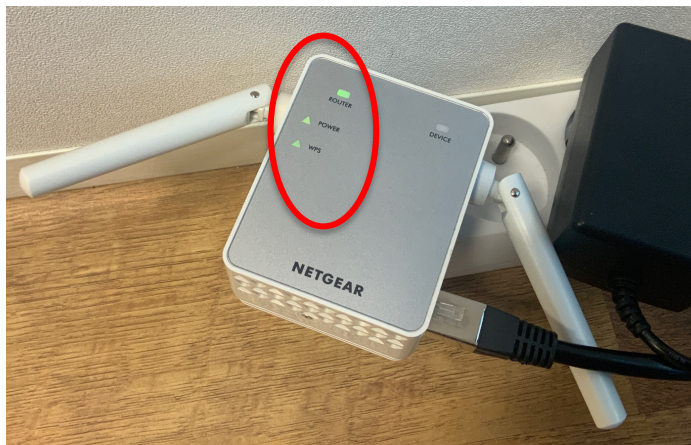

The 3 left lights of the repeater will turn green after several seconds, indicating the repeater is working fine.

If the «Router» light is not green, the repeater failed to connect to the iCare Wi-Fi and the imagyn App will not be able to detect the NAS (and will not be able to save the data).

If so:

- unplug the repeater;
- reboot the iCare;
- wait for the iCare to be on stand-by mode;
- plug the repeater back.



STEP 4: ICARE SETTINGS

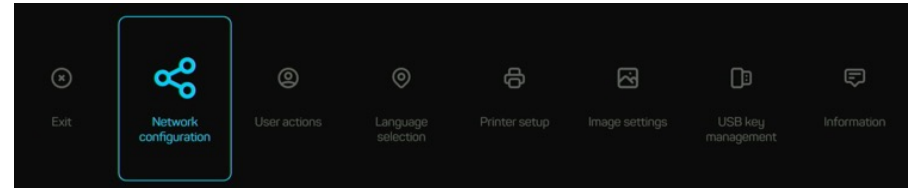
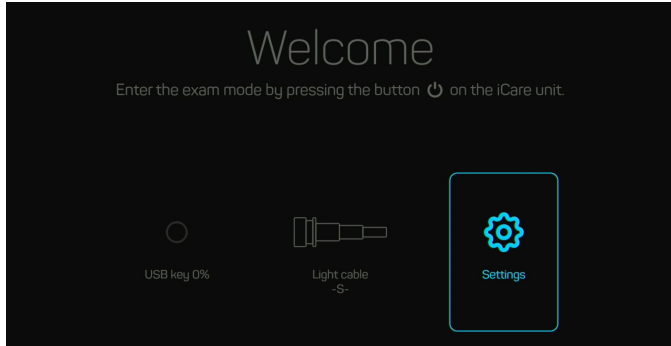

- iCare settings are implemented in the HMI displayed on the monitor.

- Navigate in the HMI thanks to the camera head buttons and go to "Settings"



Network configuration

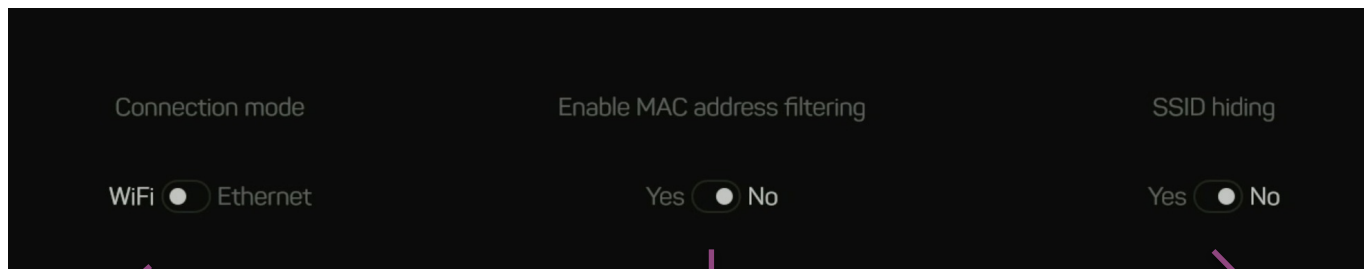

- Choose if the iPad will be connected through Wi-Fi or Ethernet to the iCare.
- **If requested by the health center,** select MAC Filtering: Only authorized devices will be able to connect to the iCare Network.
- **If requested by the health center,** select SSID hiding: The "iCare-XXXX" network will no longer appear in the list of available networks on the iPad. To be able to connect to the iCare, go to the Wi-Fi settings and enter the iCare-XXXX Wi-Fi ID in "Other..."

User Actions (1/2)

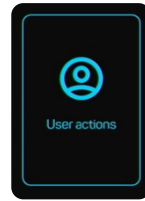

- Program the right button of the camera according to the doctor needs.

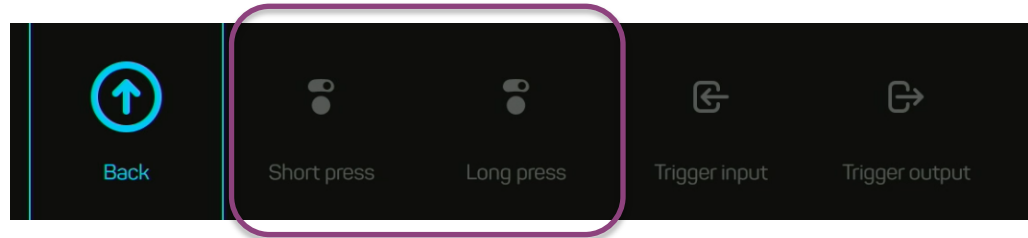

The short and long press of the right button can be used for either anti-moiré filter, gain (+10) or digital zoom (x1; x1,5; x2) control.

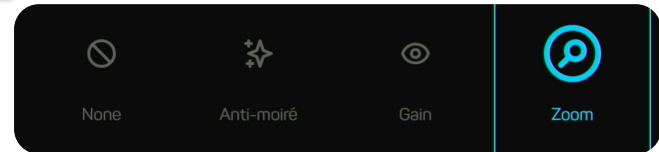

User Actions (2/2)

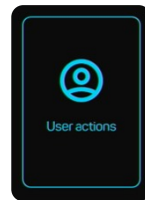

- Set up the trigger input and output if devices are connected.

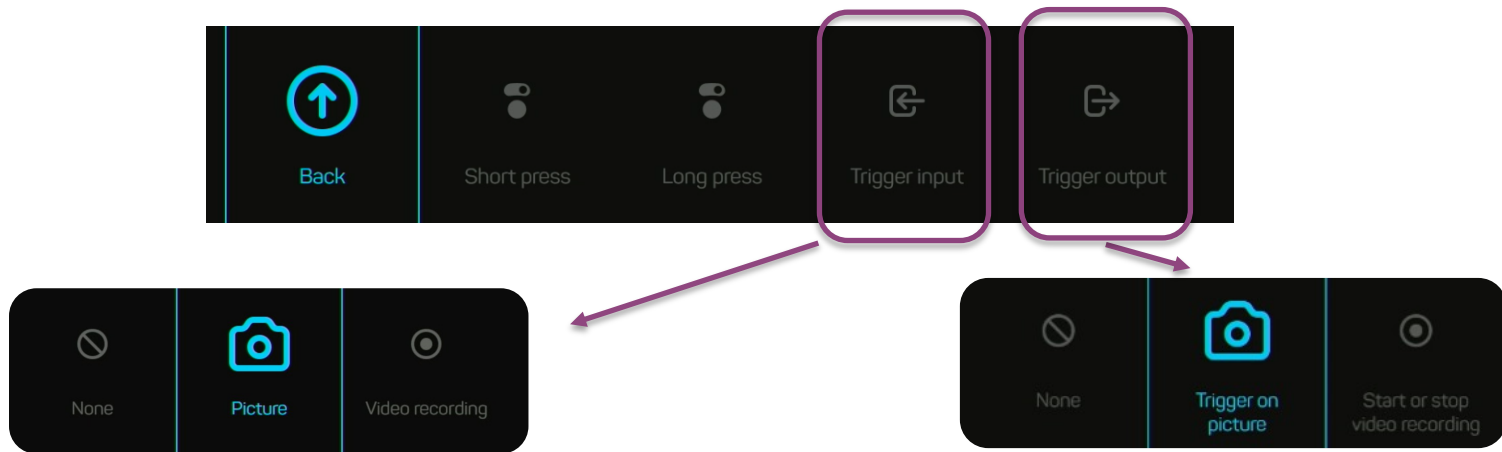

Trigger input: Choose the action the iCare must do when it receives the trigger signal from the input device (foot pedal for example).

Trigger output: Choose the iCare action that will send the trigger signal to the connected output device (recorder for example).

Language selection



- Select the language of iCare.

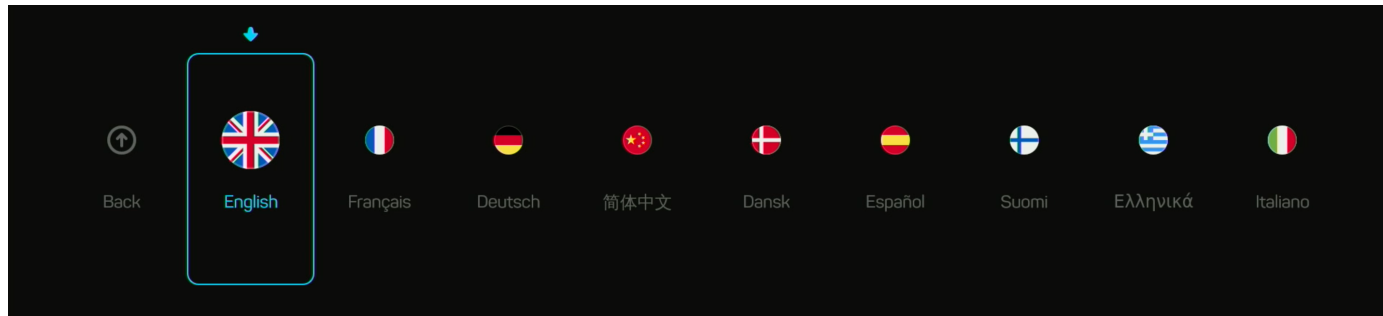
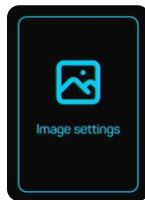
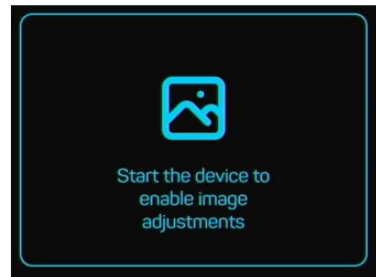

Image Settings



- Press the selection button to activate the exam mode.



- Select directly one of the three image pre-sets (neutral, warm or cool) according to the doctor preferences.

Or do a personalized image settings. You can change the brightness, blue gain, red gain, gamma, sharpness and saturation.

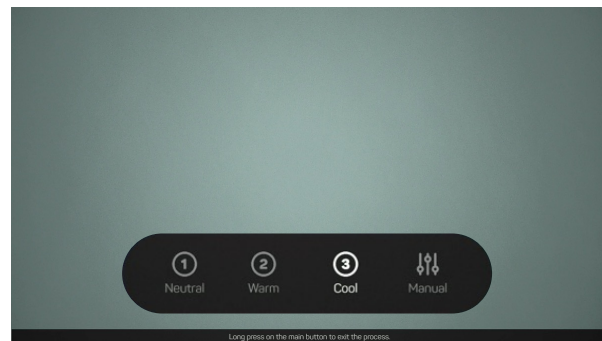



STEP 5: IPAD

Activate the iPad

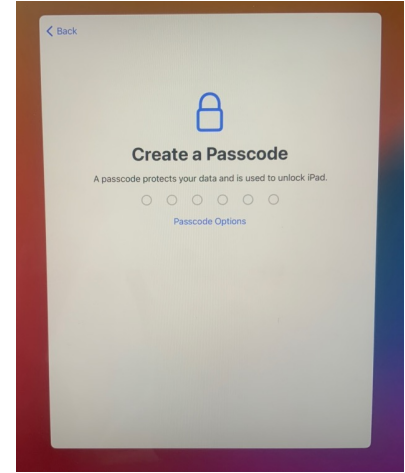
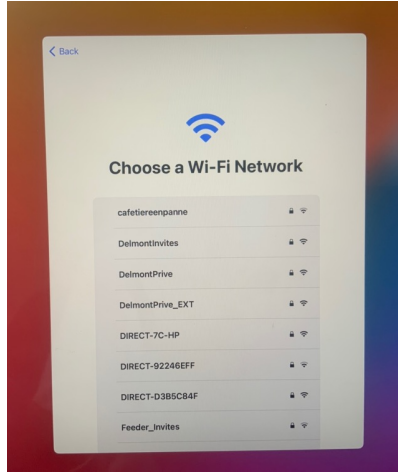
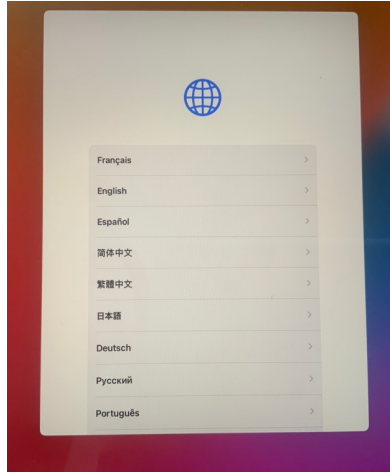

1. Turn on the iPad and choose the language and country.

2. Choose your Wi-Fi network and enter the password.

The chosen network must have internet connection.

3. - Go through the different settings: Data&Privacy and Face ID.
- Create a Passcode, it will be used to unlock the iPad. You can choose other options in « Passcode Options ».

Creation/addition of the Apple Id

To download imagyn on the App Store, you must either **use** an existing Apple Id or **create** a new one (and preferably without adding any credit card). The creation of an Apple Id **implies the presence of a person from the health center** (possibly the administrator).

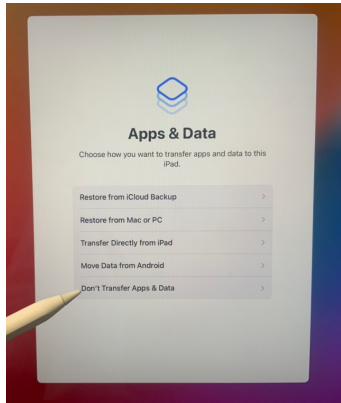

4. In the setting «Apps & Data», select «Don't Transfer Apps & Data ».

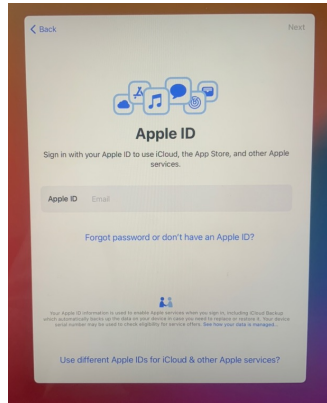

5. Select «Forgot password or don't have an Apple ID». *OR if your client has already an Apple ID, enter the ID and password.*

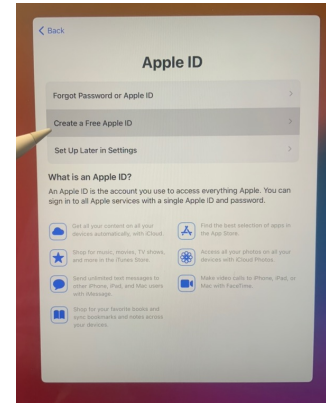

6. Choose «Create a Free Apple ID».

- Set the Name and Date of Birth of the Apple ID.
- Set the Password.
- Set a phone number (it will be used to verify the identity via a text message).
- Accept the «Terms and Conditions».

Various settings

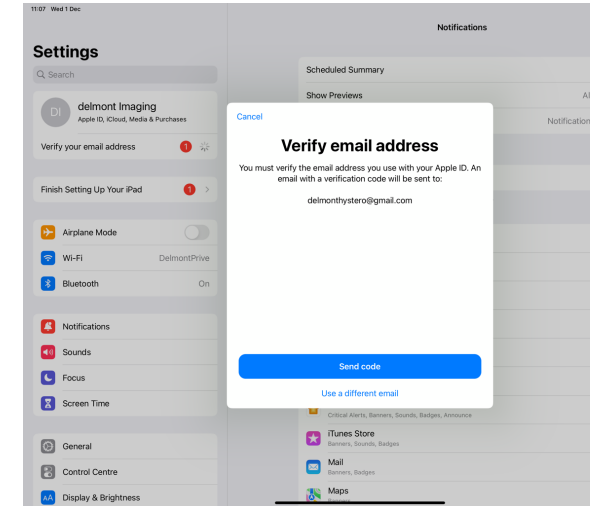
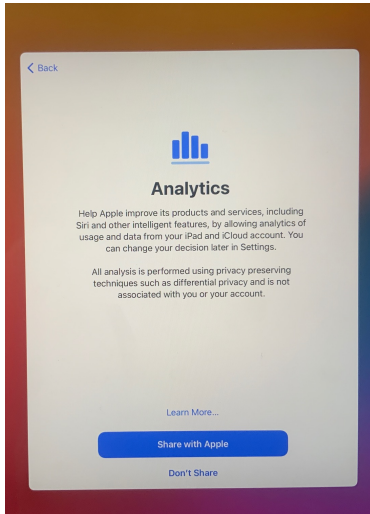

7. - Share data with Apple (not mandatory but it will help to solve imagyn app glitches).
- Go through the various next settings until «Welcome to iPad».

8. Verify your email address in the settings.

Pairing of the Apple pencil

Place the Apple pencil on the magnetised space on the top of the iPad for pairing.

Without pairing, the iPad will not recognize the Apple Pencil.





STEP 6: IMAGYN

Download imagyn App

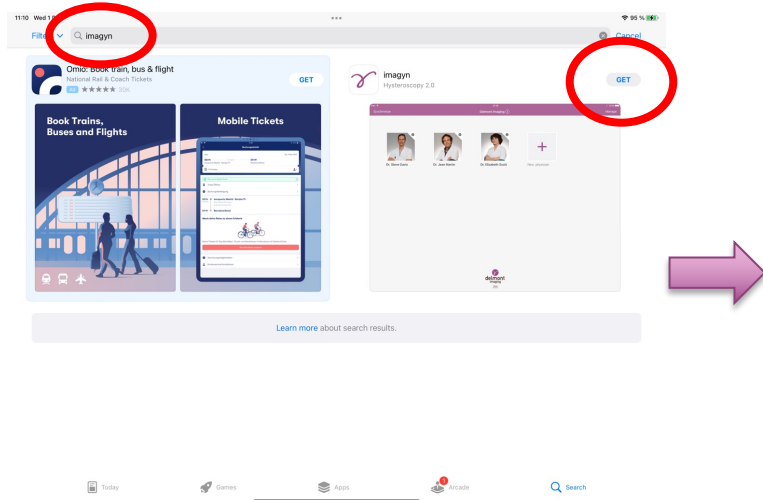

1. Download imagyn application in the App store.

- Look for «imagyn» in the research bar and click on «Get».
- You will be asked for your Apple ID password to download the App.

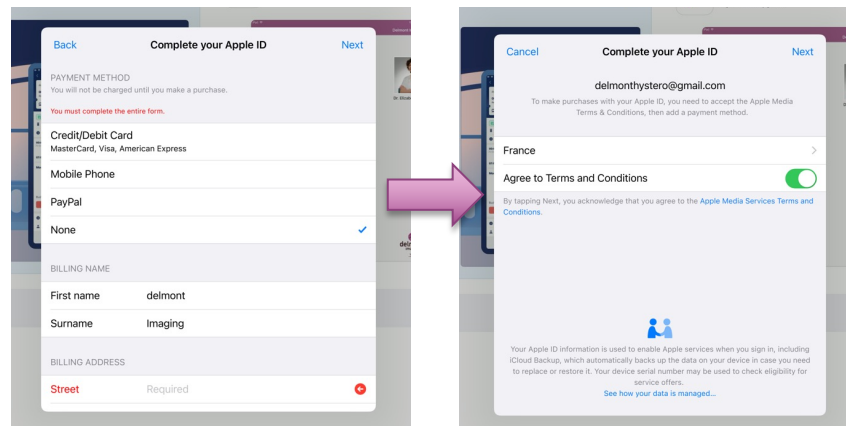

2. If you have never used the Apple ID before, agree to the terms and conditions and complete a billing address.

Then you can try again to download the imagyn App by clicking on « Get ».

Open imagyn

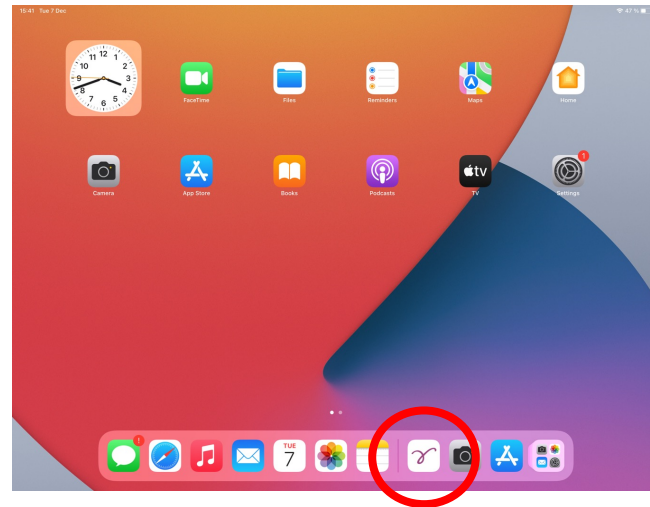
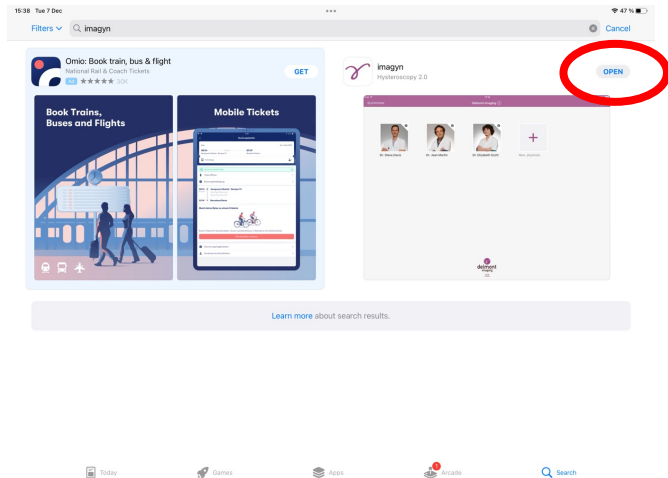

3. When the App is downloaded, click on «Open» or click on the App in the main menu.

Scan the QR code licence (1/2)

4. At the first opening, a **license QR code** is requested.

- **OPTION 1: No back up licence**

Take the licence card located in your iCare packaging. Your iPad must remain connected to a **Wi-Fi with internet connexion**.

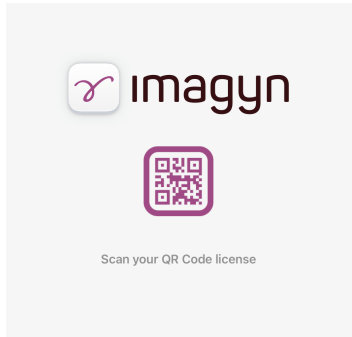

Click on the purple QR code logo.



Scan the QR code of your licence by placing it in front of the iPad camera.

Scan the QR code licence (2/2)

- **OPTION 2: NAS licence**

Take the licence card located on the NAS.

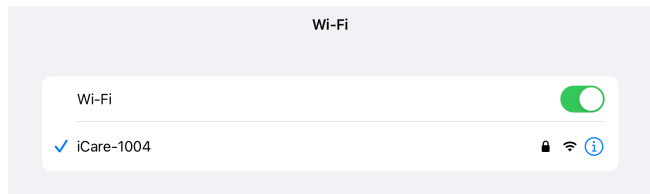

Go to the iPad Wi-Fi setup and connect the iPad to the iCare-XXXX network.



The password is indicated in the quality control certificate delivered with the iCare.

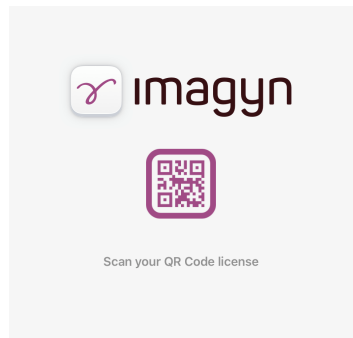

Click on the purple QR code logo.



Scan the QR code of your licence by placing it in front of the iPad camera.

Creation of the health center

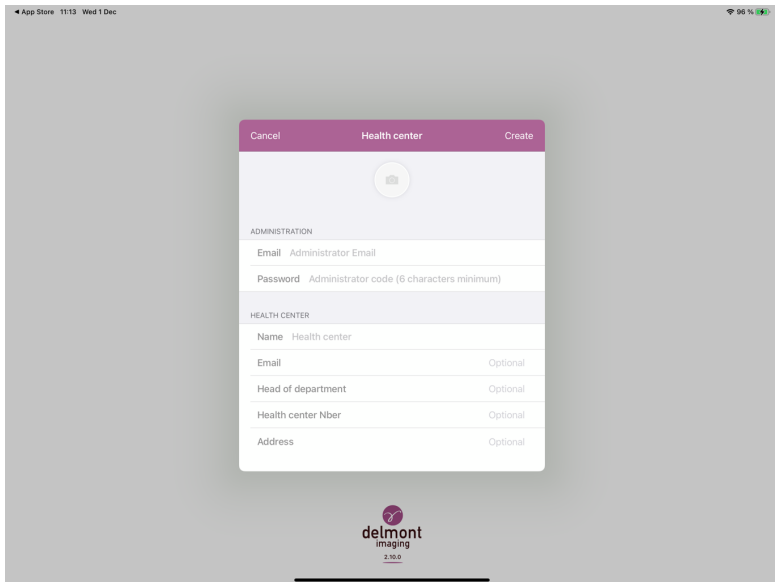

If the license is valid, you will access a form to create your health center, which you must complete:

- Administrator's email *
- Administrator's password *
- Name of the health center *
- Choose if you want a shared center (all patient records are present in all physician accounts) *
- Photo / logo
- Email of the health center
- Name of the department head
- The number of the health center
- The address of the health center

* = mandatory fields



STEP 7: NETWORK SETTINGS

iPad connection to iCare Wi-Fi

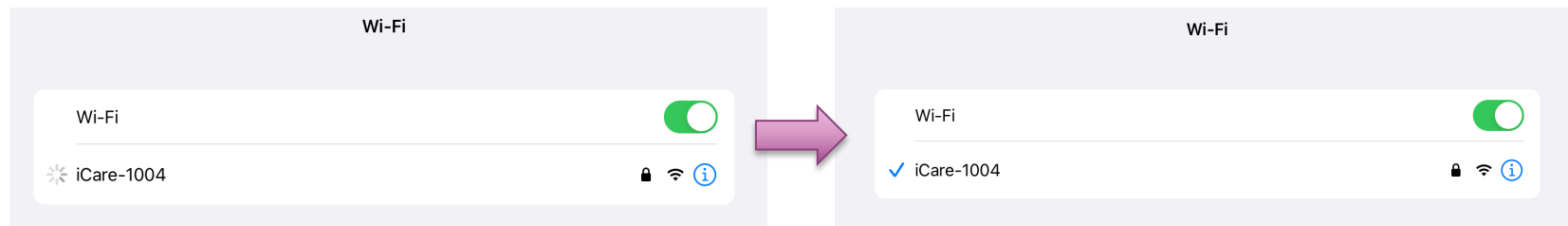

1. Connect the iPad to the iCare-XXXX Wi-Fi.

→ Go to the iPad Wi-Fi setup and connect the iPad to the iCare-XXXX network.



The password is indicated in the quality control certificate delivered with the iCare.



iCare connection to the Health Center network (1/2)

You need to have a network connection through the iCare to send the exam report by e-mail, use a printer... If the iCare can not have a Wired (Ethernet) connection to the health center network, you can connect the iCare to the Health center Wi-Fi:

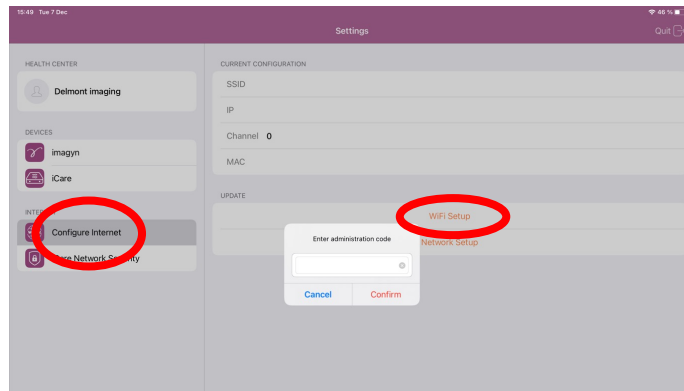
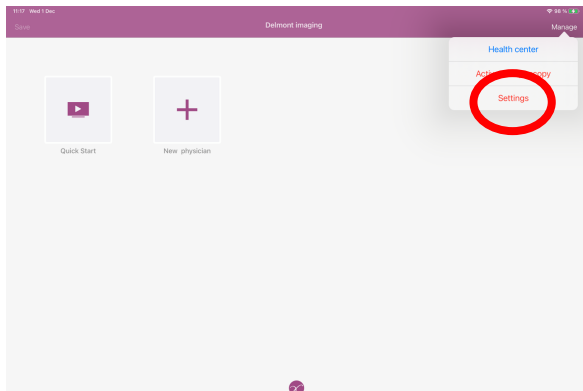

2. Go to «Manage» and select «Settings».

3. Go to «Configure Internet» and «WiFi Setup».
• You will then need to enter your administration code.



iCare connection to the Health Center network (2/2)

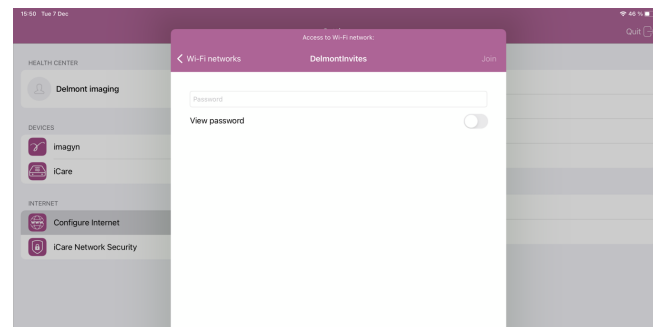
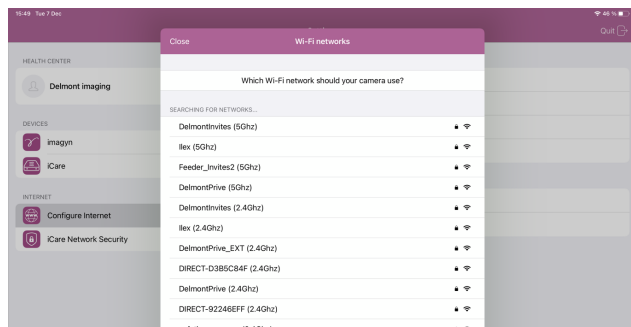

4. Choose the Health Center Wi-Fi.
Choose a 5GHz Wi-Fi network if available.

5. Type the Wi-Fi password and click on «Join».
The Wi-Fi name on the list will turn orange and then green, indicating that the iCare is correctly connected.

Network security (1/2)

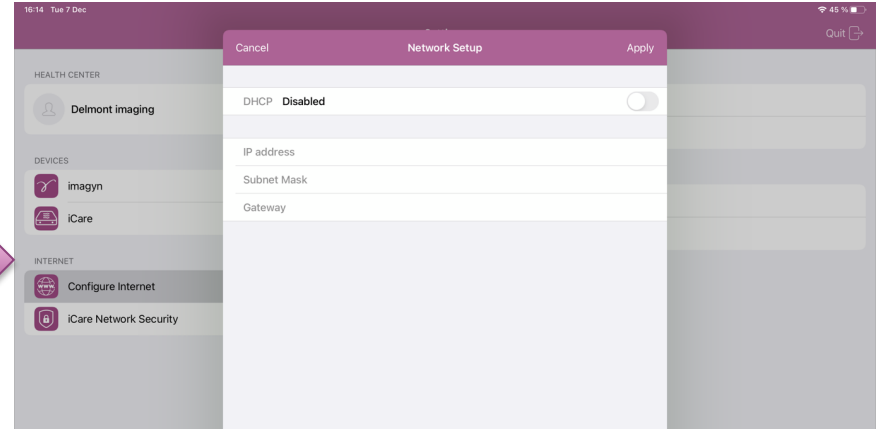
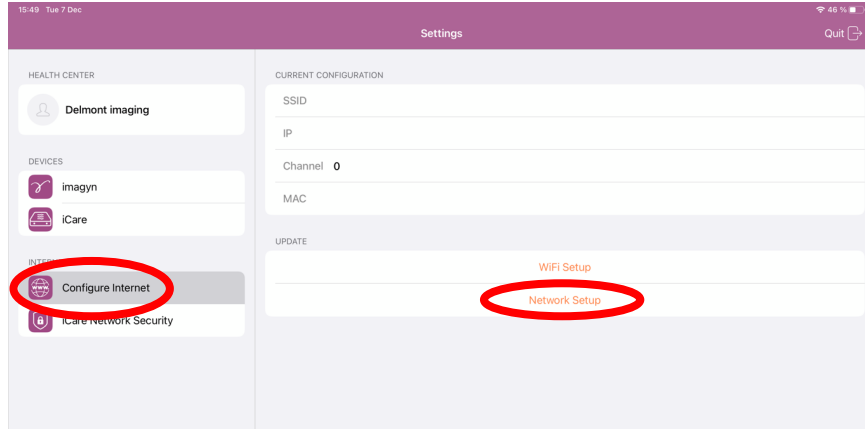

6. Configure a fixed IP address, **if imposed by the health center.**

- Go to «Configure Internet» and «Network Setup».
- You will then need to enter the administration code.

- Unselect «DHCP».
- Enter the IP address, Subnet Mask and Gateway provided by the health center.
- Select «Apply». The iCare will reboot.

Network security (2/2)

7. You can configure the iCare Network Security from imagyn in the same way as in the iCare settings (*slide 27 « Network configuration »*)

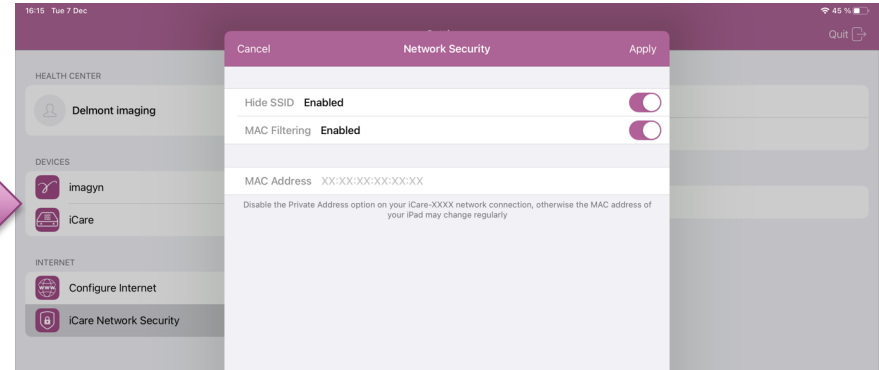
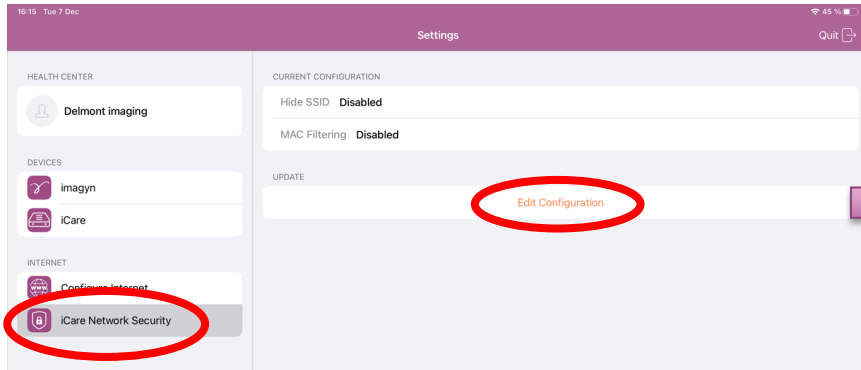

- Go to «iCare Network Security» and select «Edit configuration».
- You will then need to enter your administration code.

If imposed by the Health Center.

- Select "Hide SSID" and/or "MAC filtering". If you select MAC filtering you will have to enter the MAC address of the iPad in the authorized devices list.
- Select "Apply". The iCare will reboot.



STEP 8: FUNCTIONAL CHECK

Operational test

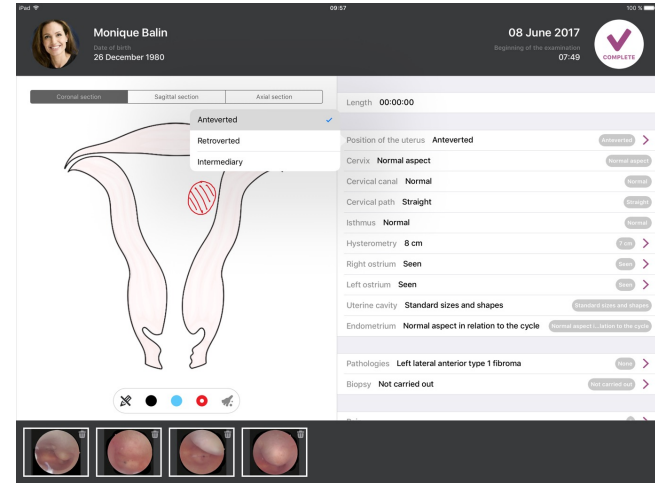

- Perform a false exam on imagyn to check if the stream is operational and if the iCare Wi-Fi stability is fine (no freeze, green screen on the iPad).
- Take pictures during the false exam.
- Create the exam report.



ANNEX 1: ICARE INSTALLER INTERFACE



- Connect the iPad or a computer to the iCare Wi-Fi.
- Type the address: <http://192.168.3.254:2016> in the navigator.
 - Login: iCare-XXXX
 - Mdp: Delmont-YYYY
(XXXX: iCare serial numbers)
(YYYY: reversed serial numbers)

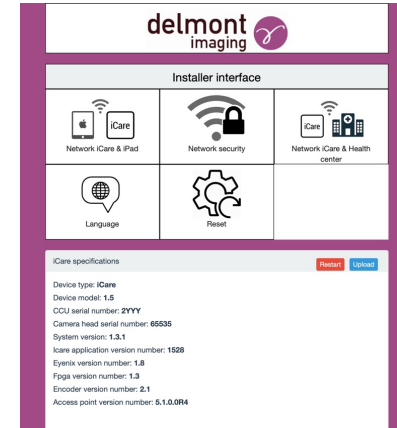

On the interface home page, you can find iCare information: model, serial number, versions, network, configuration.



Network iCare & Health center



Network iCare & Health
center

Network setup between iCare & Health center

Network setup WiFi setup

Available WiFi networks:

SSID	Band	Channel	Security	Signal
TP-LINK_7026	2.4GHz	1	WPA2	100%
Delmont_wifi	2.4GHz	9	WPA2	100%
Delmont_wifi	5GHz	36	WPA2	100%
AM_Test_2.4G	2.4GHz	11	WPA2	62%
AM_NET	2.4GHz	11	WPA2	62%
AM_Guest	2.4GHz	11	OPEN	62%
AndroidAP	2.4GHz	1	WPA2	66%

Close

Wi-Fi setup

Select the desired Wi-Fi network. After entering the password, the network banner changes to green when the iCare is properly connected.

Prefer 5GHz networks when available!

Network setup between iCare & Health center

Network Settings WiFi Settings

DHCP ☒

IP address: XXX.XXX.XXX.XXX

Netmask: XXX.XXX.XXX.XXX

Gateway: XXX.XXX.XXX.XXX

Primary DNS: 192.168.20.10 (Optional)

Secondary DNS: 192.168.1.13 (Optional)

NTP Server: XXX.XXX.XXX.XXX (Optional)

Save

Close

Network setup

On request, you can configure the IP address of the iCare with the information provided by the health center.



iCare-iPad network configuration



Network setup between iCare & iPad

Mode :

☐ Ethernet

☒ WiFi

WiFi channel:

EUROPEAN UNION

40MHz

38

SubNetwork Address:

192.168.3.0

Save

Close

You can choose a **Wi-Fi or Ethernet connexion between the iPad and the iCare.**



If needed, you can change the Wi-Fi channel of the iCare.

To do so, open a Wi-Fi analyser App on your phone to choose a channel that is not overlapping other networks.

Network Security



Network security

Only on request from the customer!

iCare network security

Hide SSID

Wireless MAC filtering

Whitelisted MAC address:

9c:e6:5e:c7:2f:31	
<input type="text" value="XXXXXXXXXXXX"/>	

Save & reboot

Close

Hiding iCare Wi-Fi:

The iCare Wi-Fi network will no longer be viewable in the available networks.

To be able to connect to the iCare network from the iPad, you must go to the Wi-Fi settings and enter the iCare-XXXX Wi-Fi ID in "Other..."

MAC Filtering:

Only authorized devices will be able to connect to the iCare network. Authorized MAC addresses must be entered one by one.



Language



Language

and Reset



Reset

Language setup

French

Save

Close

Factory reset

This will erase all configuration and system will reboot.
Are you sure ?

Cancel

OK

Close

The language of the iCare can be selected using the drop-down menu.

iCare Reset resets the initial factory configuration:

- SSID masking and MAC filtering in OFF
- Reset the USB key counter to 0
- Resetting Wifi settings



ANNEX 2: SPECIFIC WAYS TO EXPORT THE IMAGYN EXAM REPORT

Printer

You can use a printer to print the imagyn exam report directly from the imagyn App.

- Go to *ANNEX 3 “Configuration with Printer”* to connect the iCare to the printer.

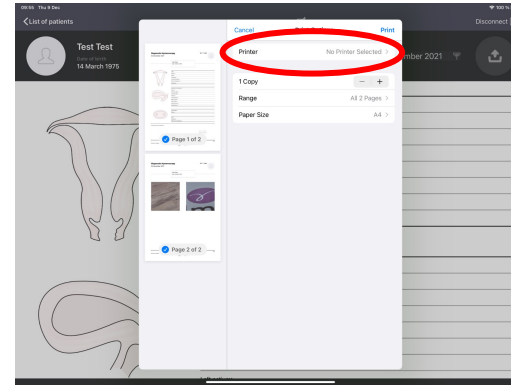
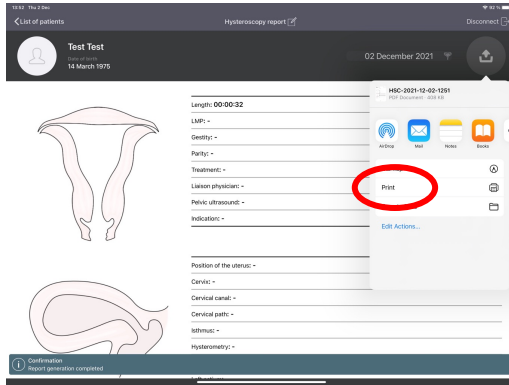

- Select “Print”.

- The first time you will need to select the printer by going on “Printer”.

Shared file (1/3)

If the health center has a local network, a shared file dedicated to the imagyn exam reports can be created. The doctors will be able to save directly the exam reports in this file from the iPad. They will then be able to access those exam reports from the office computer.

- iPad files



1. Go to "Files".

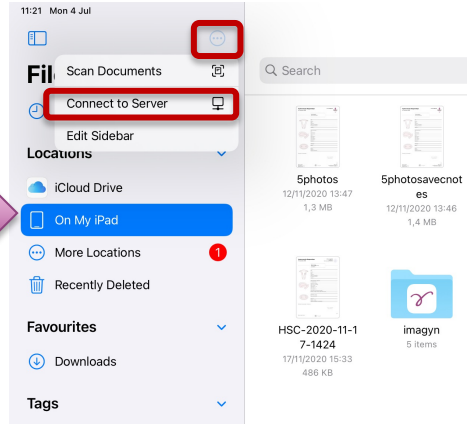

2. Select "...", and "Connect to Server".

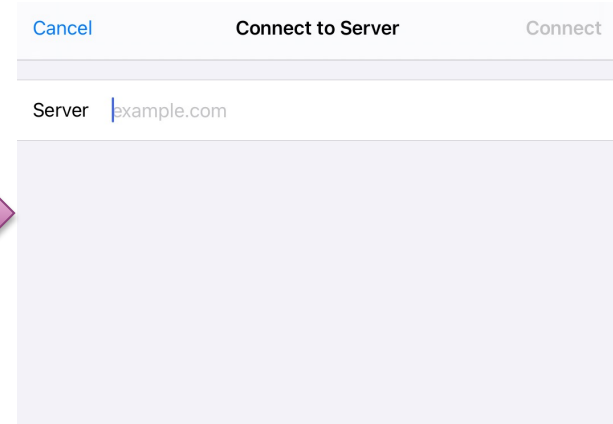

3. Enter the IP address of the server and click on "Connect".

Shared file (2/3)

Cancel **Connect to Server** Next

CONNECT AS:

Guest

Registered User ✓

Name Username

Password Optional

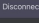

Hysteroscopy report  Disconnect

26 March 2022
30 August 2017
18 June 2017

HSC-2017-08-30-1000
PDF Document - 416 KB

Length: -

LMP: 21/08/2017

Gestty: 0

Parity: 0

Treatment: None

Liaison physician: Dr. Farl

Pelvic ultrasound: Normal

Indication: Post-operative control

Position of the uterus: Anteverted

Cervix: Normal aspect

Cervical canal: Normal

Cervical path: Straight

Isthmus: Normal

Hysterometry: 7 cm

Right osium: Seen

Save to Files



Choose a new location to save this item.

HSC-2017-08-30-1000

iCloud Drive

On My iPad

Server name

4. Enter the login name and password and click on "Next".

5. To check the proper functioning, try to export an imagyn exam report:

- Select "Save to files".
- Select the server and file.
- Check that you can have access to the exam report from a computer of the health center.

Shared file (3/3)

- DS files



1. Download “DS file” App on the Appstore.

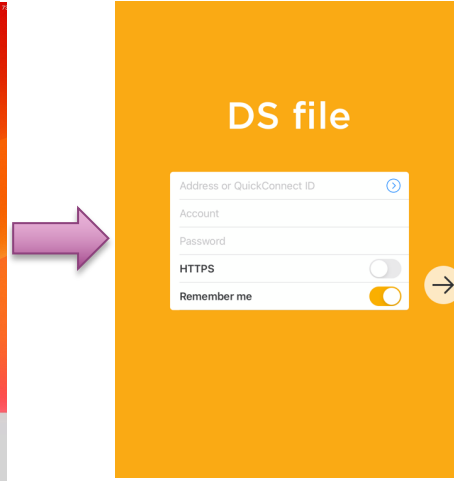

2. Enter the server IP address, the login name and password.

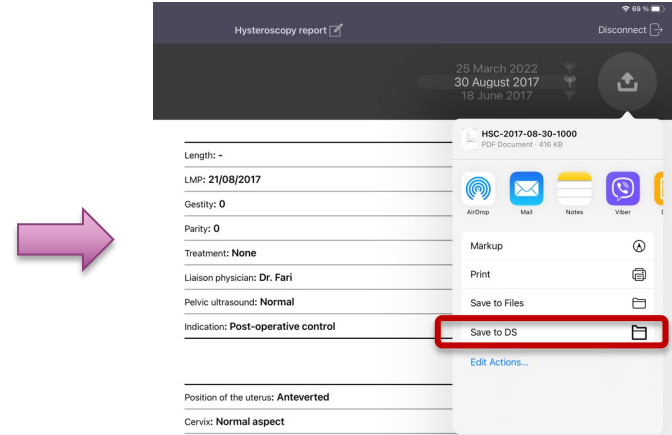

3. To check the proper functioning, try to export an imagyn exam report:

- Select “Save to DS”.
- Select the server and file.
- Check that you can have access to the exam report from a computer of the health center.

E-mail (1/2)

To send the exam report by e-mail, you need:

1. To configure a professional secured e-mail address on the iPad e-mail App:

2. To have access to the health center network through the iCare.

- If the network of the health center have an **internet connection**, make sure you have connected the iCare to the health center network. (See “NETWORK SETTING”)
- If you can't connect the iCare to internet (or during a demo) you can **share the internet connection with a smartphone**.
- In a hospital with a secured network without internet, you can ask the computer service to **connect the iCare to the hospital network only to send emails**. You will need to have a wired connection with the Health center, (Slide 16. “Connection to the health center”) and to configure an authorized IP address given by the hospital (slide 46. “Network security”). The IT service will need to configure the e-mail address on the iPad.

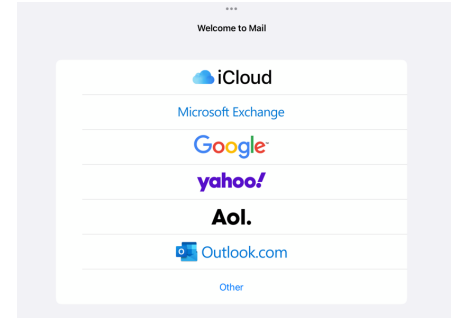

E-mail (2/2)

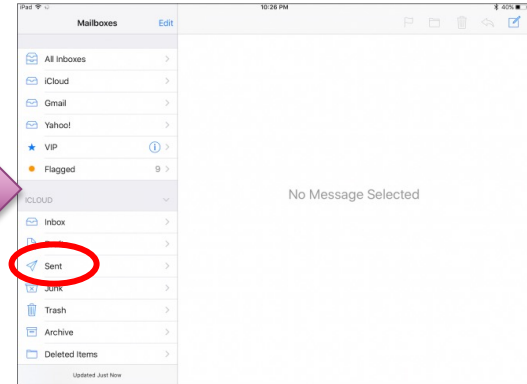
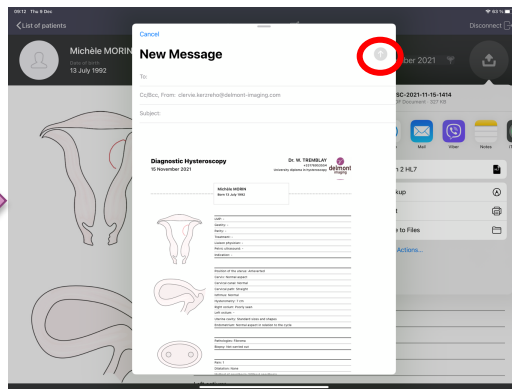
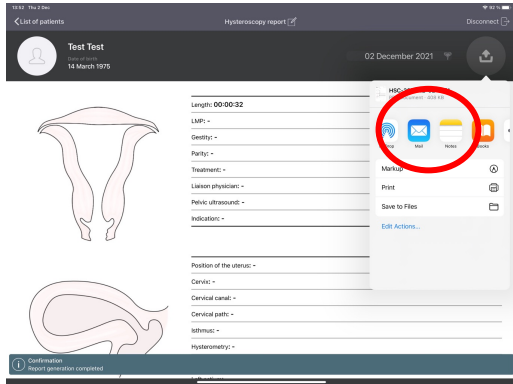

- Select « Mail ».
- Choose the recipient's e-mail address and Subject before sending the e-mail.
- You can check that the e-mail was correctly sent by going in the « mail » App of the iPad. Check the e-mail is in the « Sent » box.

USB Key

If you don't have access to the health center network or internet, you can save the imagyn exam report on a USB key.

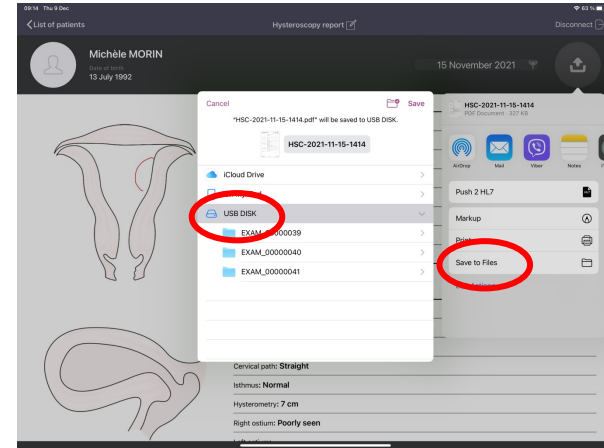

- Use a USB C/USB adaptor to connect a USB key to the iPad.
Or use directly a type C USB key.
- Go to “Save to Files” and choose the name of your USB key.



If the customer has a Macbook computer or an iPhone, you can use "Airdrop" for an easy and quick transfer of the imagyn exam report.

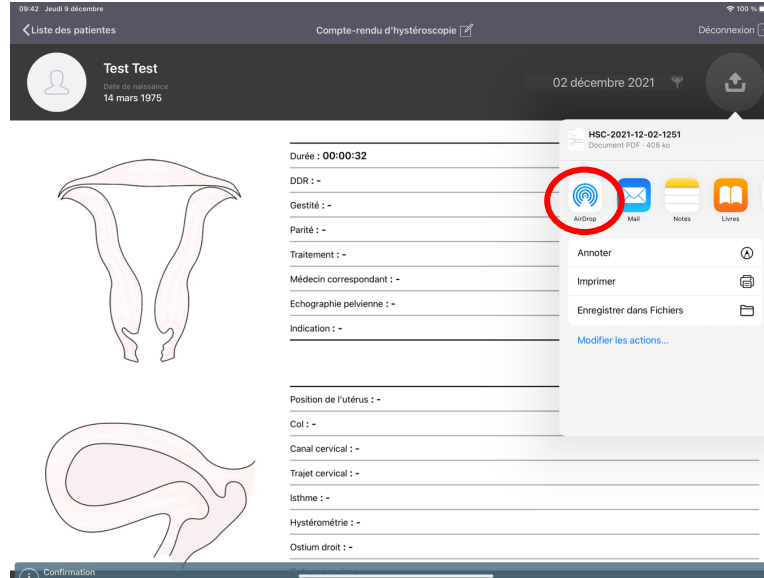



ANNEX 3: SPECIFIC INSTALLATIONS

Configuration with AirPrint printer (1/3)

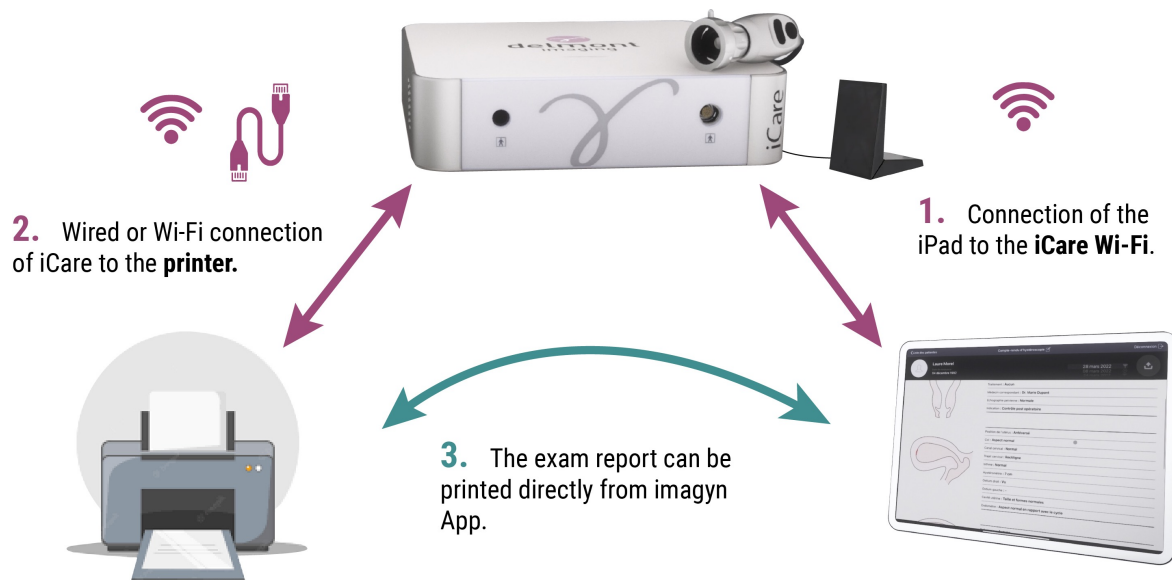

Configuration with AirPrint printer (2/3)

There are 3 different configurations for a AirPrint printer to be detectable by the iCare.

- **The printer is connected to the iCare Wi-Fi**
→ The printer can only be used to print the imagyn report.

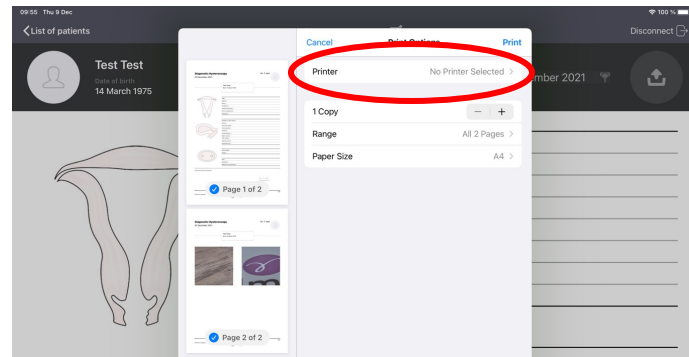

Configure the iCare Wi-Fi SSID (name of the Wi-Fi network) in the parameters of the printer.

- **The printer & the iCare are both connected to the health center network**

You must have a Wi-Fi or Wired connection to the health center (*Slide16. « Connection the the health center »*).

Configuration with AirPrint printer (3/3)

- **Wired connection of the printer to the iCare**

→ The printer can only be used to print the imagyn report

1. Connect an Ethernet cable between the RJ45 outlet of the iCare and the printer.
2. Connect the iPad to the iCare Wi-Fi and open imagyn application.
3. Go to “Settings” and “Configure internet”.
4. Disabled “DHCP” and enter a fixed IP iCare address, Subnet Mask and Gateway (provided by the health center). Select “Apply”.
5. Configure a fixed IP address in the printer.

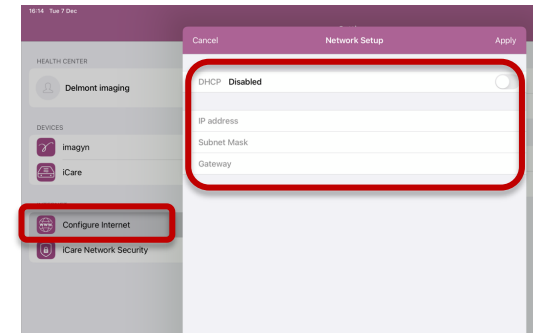
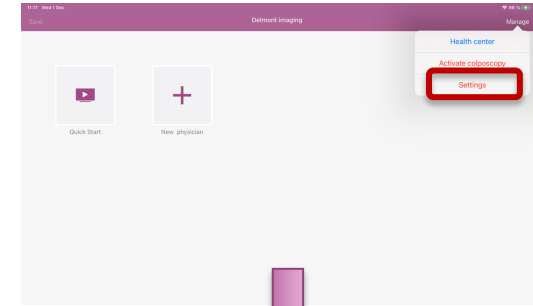

Configuration with non-AirPrint printer (1/4)

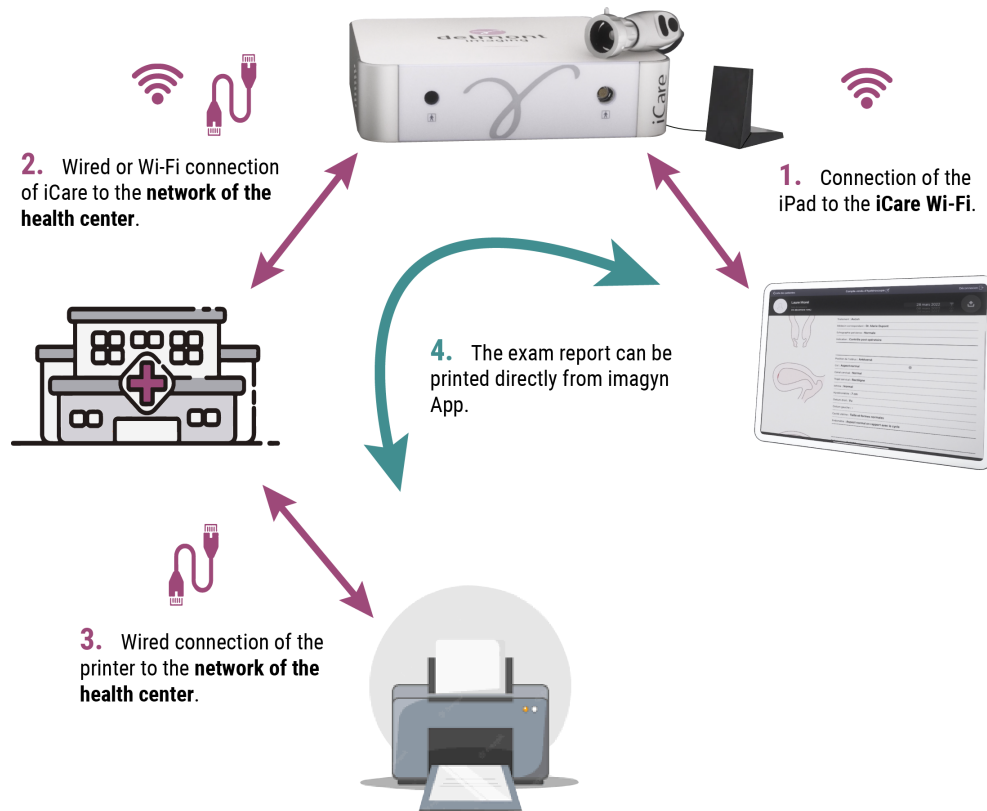

Configuration with non-AirPrint printer (2/4)

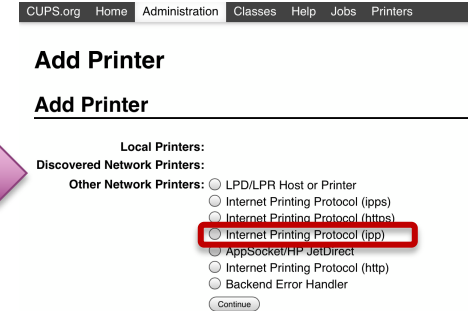
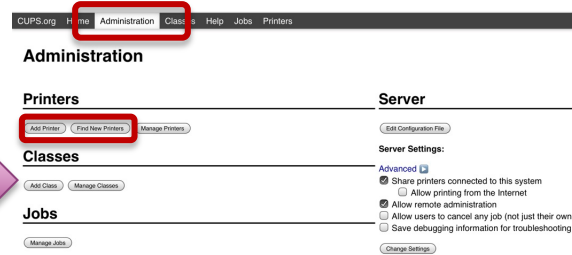
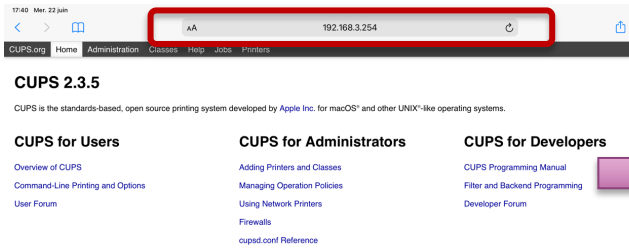

1. - Connect the iPad to the iCare Wi-Fi.

- Go to <http://192.168.3.254:631> address in the navigator.

2. In "Administration" tab, select "Find New Printer".

- Select your printer if it appears in the list and go to step **5**.
- Otherwise, select "Add Printer" and go to step **3**.

3. Select "Internet Printing Protocol (ipp)".

*If needed: Login : printer
Password : Delmont-imaging*

Configuration with non-AirPrint printer (3/4)

Add Printer

Connection:

Examples:

```
http://hostname:631/ipp/  
http://hostname:631/ipp/port1  
  
ipp://hostname/ipp/  
ipp://hostname/ipp/port1  
  
lpd://hostname/queue  
  
socket://hostname  
socket://hostname:9100
```

See "Network Printers" for the correct URI to use with your printer.



Add Printer

Name:

Description:
(May contain any printable characters except " ", "#", and space)

Location:
(Human-readable location such as "Lab 1")

Connection:

Sharing: ☒ Share This Printer



Add Printer

Name: ICareprinter

Description:

Location:

Connection: ipp://192.168.20.45/ipp/print

Sharing: Share This Printer

Make:

Or Provide a PPD File: no file selected

4. - Enter:
ipp://<IP_imprimante>/ipp/print
- Select "Continue".

5. - Enter a name and
select "Share This Printer".
- Select "Continue".

6. - In "Make" choose
"Generic".
- Select "Continue".

Configuration with non-AirPrint printer (4/4)

Add Printer

Name: ICareprinter
Description:
Location:
Connection: ipp://192.168.20.45/ipp/print
Sharing: Share This Printer
Make: Generic Select Another Make/Manufacturer
Model: Generic IPP Everywhere Printer (en)
Or Provide a PPD File: Choose File no file selected
Add Printer



Set Printer Options

Set Default Options for ICareprinter

General Options Installed Banners Policies

General

Media Size: A4
Double-Sided Printing: Off
Media Source: Auto-Select
Resolution: 600 DPI
Color Mode: Color (8 bit RGB)
Printout Quality: Default
Set Default Options



CUPS.org Home Administration Classes Help **Jobs** **Printers**

ICareprinter

ICareprinter (Processing, Accepting Jobs, Shared)

Maintenance Administration

Print Test Page
Pause Printer
Reject Jobs
Move All Jobs
Cancel All Jobs

Search in ICareprinter:

7. - In "Model" choose "Generic IPP Everywhere Printer(en)".
- Select "Add Printer".

8. - Choose the default options.
"Media size" should be "A4".
- Select "Set Default Options".

9. - Go to "Printers".
- In "Maintenance", choose "Print a Test Page" to check if the printer is working properly.

Configuration with Wired iPad (1/2)

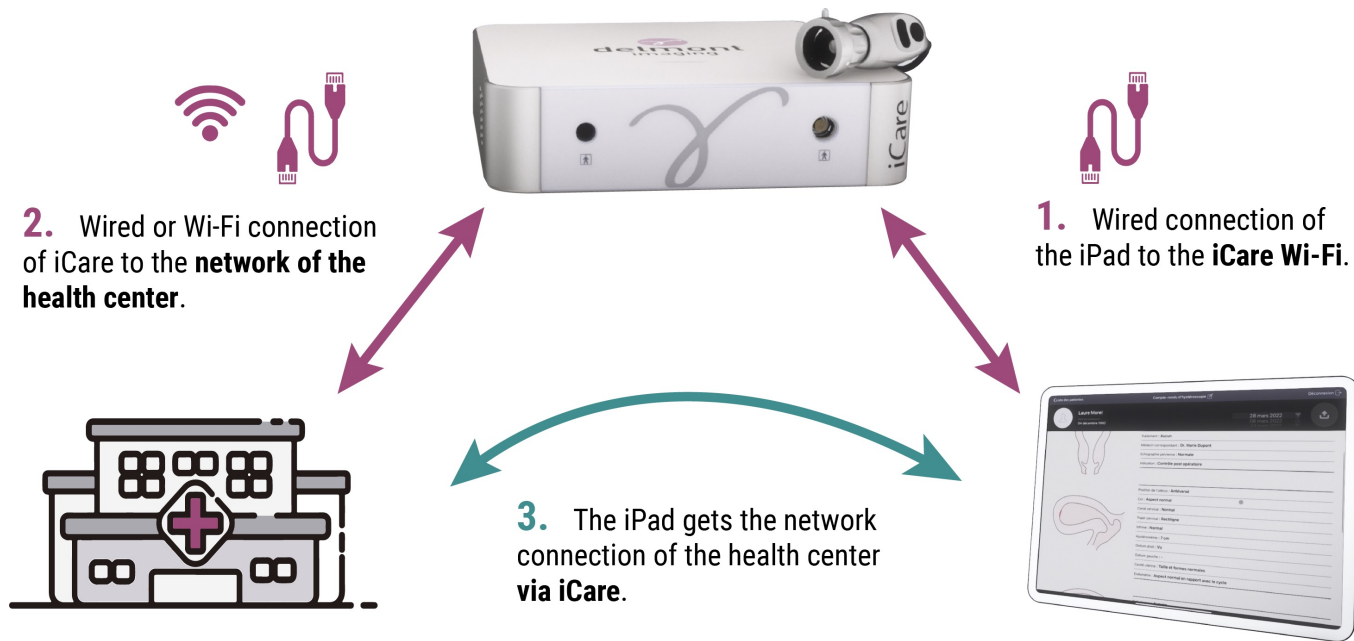

Configuration with Wired iPad (2/2)

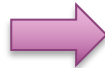
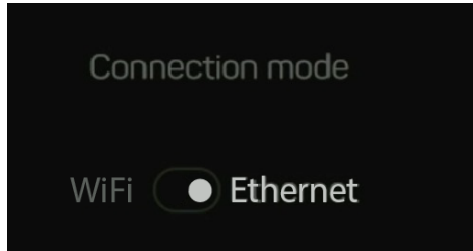

1. Go to the iCare settings (step 4), in network configuration, and select Connection mode: Ethernet.

2. - Plug a USB/Ethernet adaptor on the remaining USB socket of the iCare.
- Connect an Ethernet cable to the iCare adaptor.

3. - Connect an Ethernet adaptor to the iPad.
- Connect the other end of the Ethernet cable to the iPad adaptor.



ANNEX 4: NAS USE

NAS use

The backup on the NAS is **not automatic**, it should be done after each series of exam!

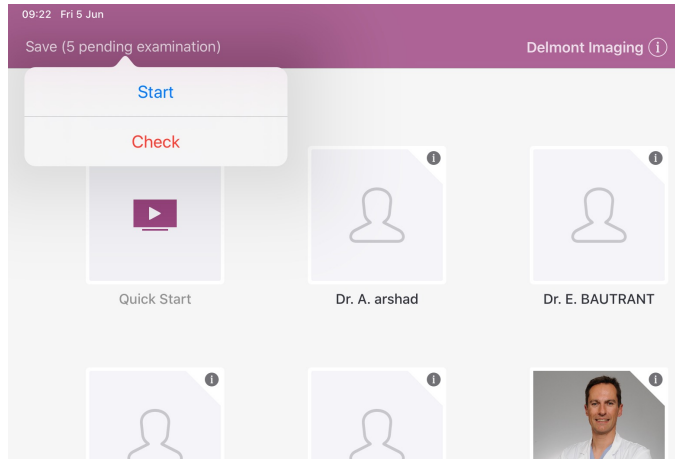

Go to « Save » and click on « Start » to start the backup.

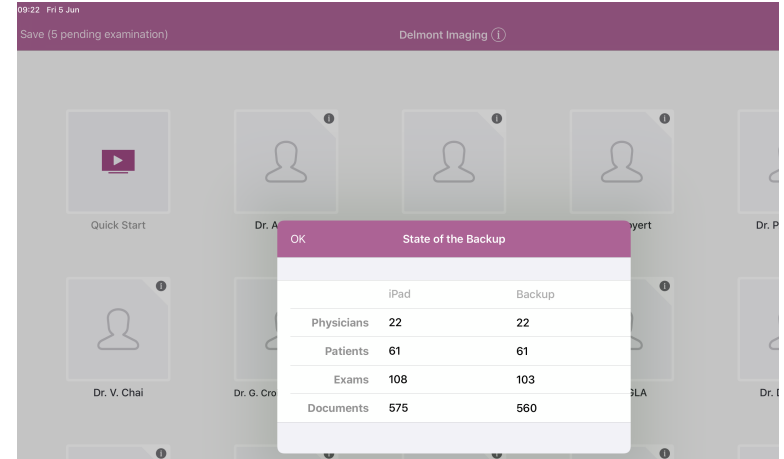

Go to « Save » and click on « Check » to check if the data are correctly saved on the NAS.



ANNEX 5: MONITOR SETTINGS

Monitor settings (1/3)

The Neovo monitor is **pre-set in-house** and it is impossible to access the setup menu in order to avoid unintentional display (tactile touch...).

If it is necessary to unlock the menu access, press simultaneously during 5seconds on:

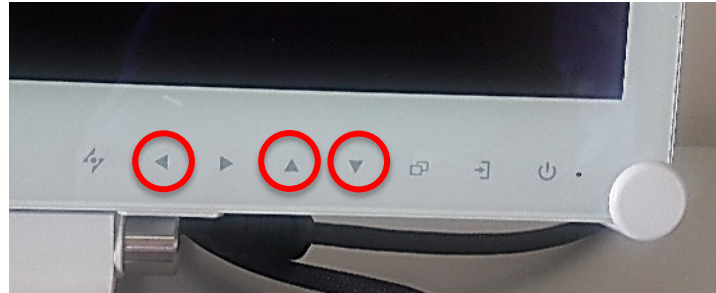

Warning, do not forget to lock it again afterwards. (*same process as to unlock it*)
When the monitor is locked, only the **standby button** is accessible.

Monitor settings (2/3)

When the monitor is unlocked, all the buttons are accessible. They allow to:

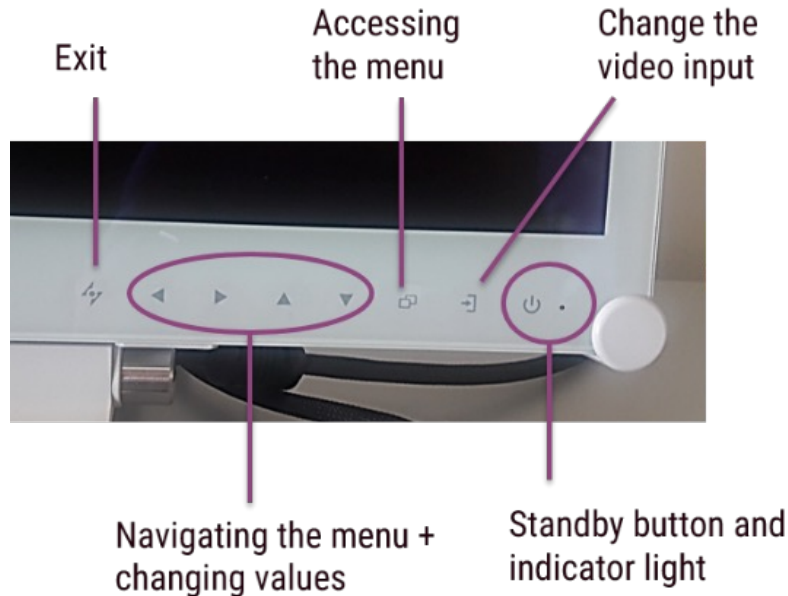

Setup menu:

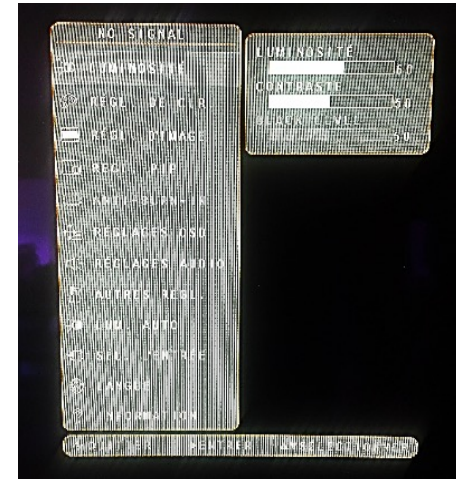

Monitor settings (3/3)

Optimal values set in-house by Delmont are:

Luminosity	Luminosity	56
	Contrast	54
	LCD backlight	80
	Blacklevel	26
Colors	Color temperature	R=107, G=90, B=122
Image settings	Sharpness	60
	Saturation	46
	Tint	50
	Gamma	2,2
	Noise reduction	MID
	Image mode	STANDARD
	Horiz. position	50
	Verti. position	50
	Phase	50
	Clock	50
Rapp aspect	Rapp aspet	Reel

	H Zoom	100
	V Zoom	100
	Over scan	0
PIP settings	PIP	OFF
	Princ. source	HDMI
Anti burn-in	Active	OFF
	Int	6
	Anti B. in mode	C
OSD settings	transparency	0
	Horiz position	7
	Vert position	50
	OSD time	15
Audio settings	Volume	50
	Audio	ON
System	Eco energy	ON
	Source detection	Manual
	DDC/C	ON

	DCR	OFF
	Blue screen	OFF
	Signal info	OFF
	Logo	OFF
Eco smart	Active	OFF



ANNEX 6: ADDITIONAL ICARE SETTINGS

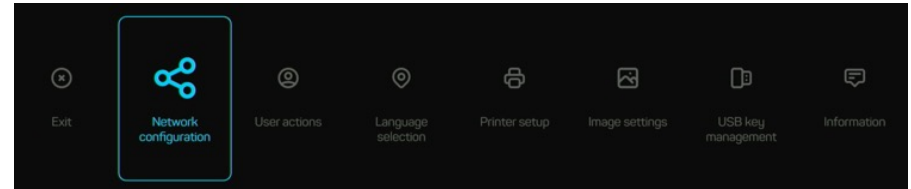
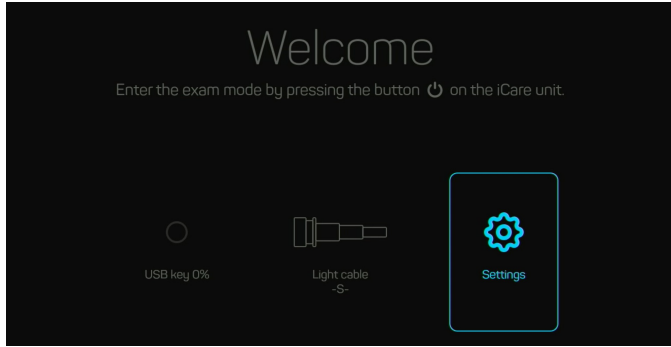

- iCare settings are implemented in the HMI displayed on the monitor.

- Navigate in the HMI thanks to the camera head buttons and go to "Settings"



Informations

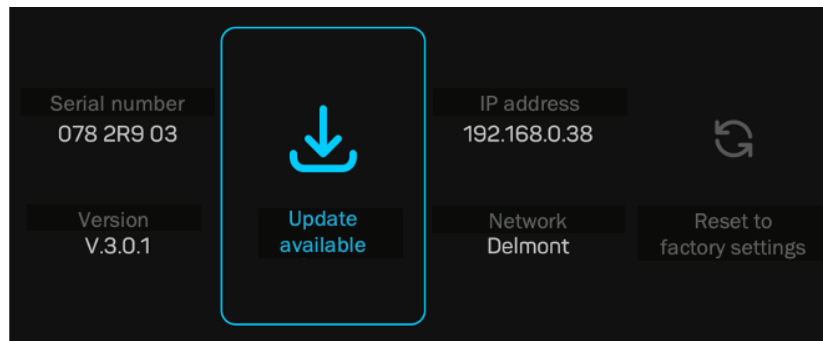
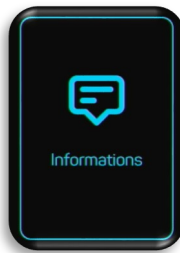

- Displays iCare information;
- Allows software upgrade of iCare (automatic detection and alert if iCare is connected to internet);
- Allows to reset to factory settings.

USB key management

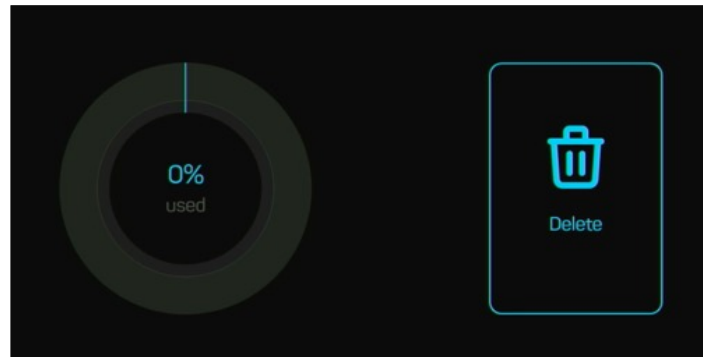
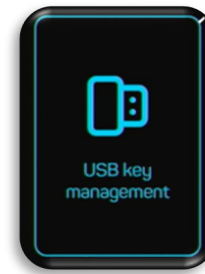

- Shows the current storage capacity of the USB connected and offers the possibility to directly delete it from iCare.